



12a Taylor Street | Whitworth | Rossendale OL12 8PT

[www.reside.agency](http://www.reside.agency)





# 12a Taylor Street

## Whitworth | OL12 8PT

Welcome to 'Whinny Cottage', a delightful mid-terraced property that spans over three floors set amidst the tranquil beauty of nature, this picturesque home offers a serene escape whilst affording breathtaking open countryside views.

As you approach the property, you'll be greeted by a stone facade which adds to cottages rustic charm. Step inside, and you'll discover a delightful living space that spans over three levels, providing ample room for comfortable living.

Refurbished throughout to a high standard in 2018, the ground floor welcomes you with a cosy lounge area, featuring a log burning fireplace, perfect for relaxing evenings by the fire. The adjacent kitchen boasts modern amenities while retaining its traditional character.

Ascending to the first floor, you'll find two double bedrooms with the rear bedroom overlooking the stunning countryside vistas. Wake up to the sight of rolling hills and lush greenery, creating a tranquil ambiance that rejuvenates the soul. Both bedrooms are served by a modern three-piece bathroom.

Continue your journey to the top floor, where a versatile attic room awaits, providing flexibility to suit your lifestyle needs. Whether utilised as a guest room, home office, or hobby space, this area offers endless possibilities.

Outside, the property truly shines with its enchanting surroundings. Step into the rear garden and immerse yourself in nature's beauty, with scenic walks right at your doorstep. Spend leisurely afternoons exploring the picturesque countryside or simply unwind in the peace and serenity of your private outdoor oasis.

Located within an idyllic setting, the property is nicknamed 'Whinny Cottage' after the neighing and whinnying of the horses that come daily to the fence at the back of the garden, whilst other wildlife can be spotted across the many trails of the nearby Healey Dell nature reserve. At the top of Taylor Street, the Whitworth square conservation area is home to a local dog friendly pub as well as St Bartholomews Church, dating back to 1529.

Although the cottage is over three floors, there is room for further expansion into a 'fourth' floor. Currently used as storage, the basement is ripe for future development into additional living accommodation as a comfortable family or games room.

Don't miss your chance to make this enchanting retreat your new home. Contact us today to arrange a viewing!







To view this property call Reside on **01706 356633**



### Ground Floor

Approx. 32.8 sq. metres (352.7 sq. feet)

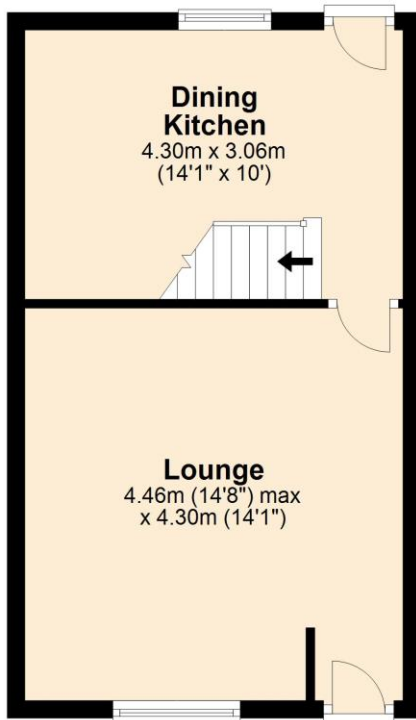

### First Floor

Approx. 32.8 sq. metres (352.7 sq. feet)

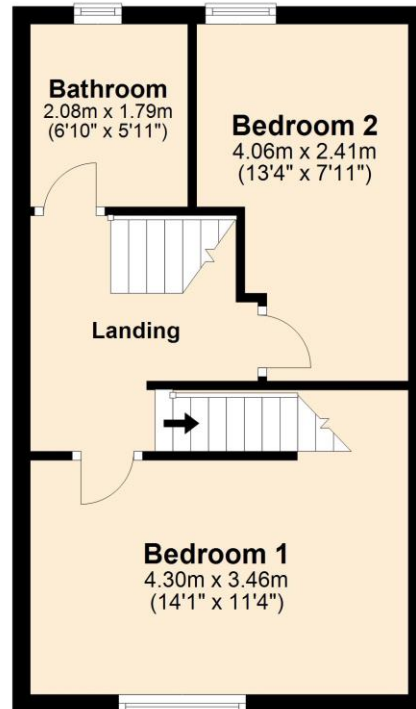

### Second Floor

Approx. 22.1 sq. metres (237.9 sq. feet)

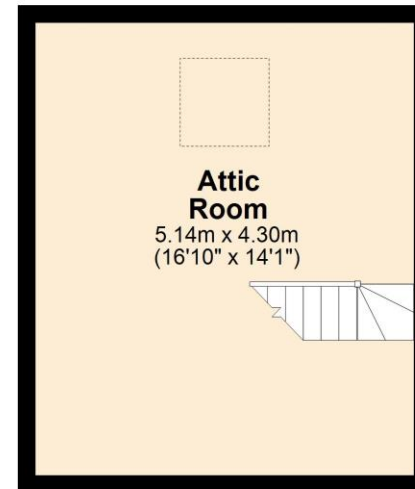

Total area: approx. 87.6 sq. metres (943.3 sq. feet)

Reside Estate Agency  
Plan produced using PlanUp.



4 Smith Street, Rochdale  
Lancashire, OL16 1TU

Tel: 01706 356633

Email: [enquiries@reside.agency](mailto:enquiries@reside.agency)

[www.reside.agency](http://www.reside.agency)

"Once you find the property you want to buy, you will need to carry out more investigations into the property than it is practical or reasonable for an estate agent to do when preparing sales particulars. For example, we have not carried out any kind of survey of the property to look for structural defects and would advise any homebuyer to obtain a surveyor's report before exchanging contracts. If you do not have your own surveyor, we would be pleased to recommend one. We have not checked whether any equipment in the property (such as central heating) is in working order and would advise homebuyers to check this. You should also instruct a solicitor to investigate all legal matters relating to the property (e.g. title, planning permission etc) as these are specialist matters in which estate agents are not qualified. Your solicitor will also agree with the seller what items (e.g. carpets, curtains etc) will be included in the sale".